

Installation Guide

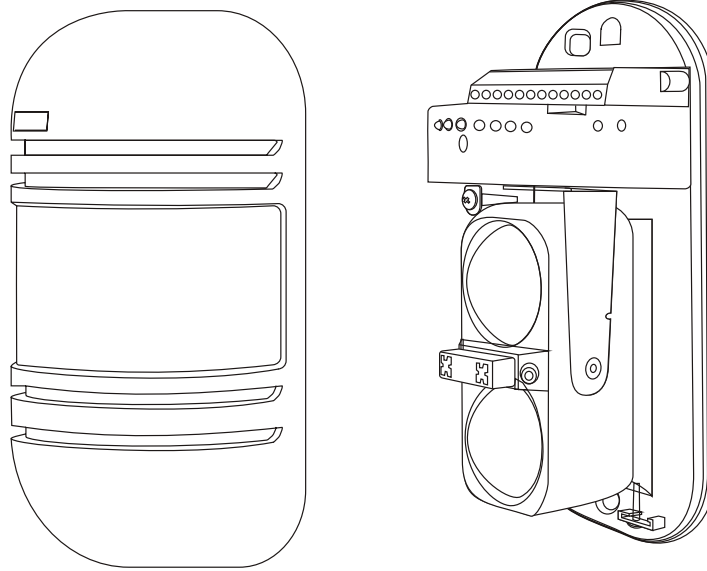

- Active Infrared Detector, composed by a Transmitter(TX) and a Receiver(RX).
- The alarm is tripped by the simultaneous interruption of all the beams of the detector.
- Fog/Rain recognition with automatic adaptation of the transmission power to the environmental conditions.
- Disqualification Feature in case of heavy fog (is a signal the detector sends to the connector pins (DISQ.) when the Transmitter is no more in condition to communicate with the Receiver, due to weather conditions like fog or heavy rain/snow)
- Aligment with viewfinder and LED indication
- Signal strength indication
- Possibility to set 8 different digital frequencies to avoid interferences
- Status and Alarm Buzzer in setting mode
- Adjustable Response Time from 50 to 240 ms.
- Tamper

1. Technical parameters

Model		ABT-30	ABT-60	ABT-100
Alert distance	Outdoor	30m	60m	100m
	Indoor	60m	180m	300m
No. of beams		2 beams		
Detection mode		2 beams blocked simultaneously		
Optical source		Infrared digital pulse beam		
Response speed		50-240ms		
Alarm output		Relay contact output: NO. NC contact rating: DC30V, 150mAMax		
Power supply		DC13.8-24V 15W		
Operation temperature & humidity		-25°C/+55°C 5-95%RH (relative humidity)		
Dimensions		See drawings		
Tamper output		Contact output: NC contact rating: DC30V, 150mAMax		
Optical axis adjustment(H)		180° (± 90°)		
Optical axis adjustment(V)		20° (± 10°)		
Protection against dew,frost		Calefaction housing (optional)		
Material		PC resin		
Net Weight		658g(receiver +transmitter)		
Gross weight		1150g		

Table:1

2. Terminology

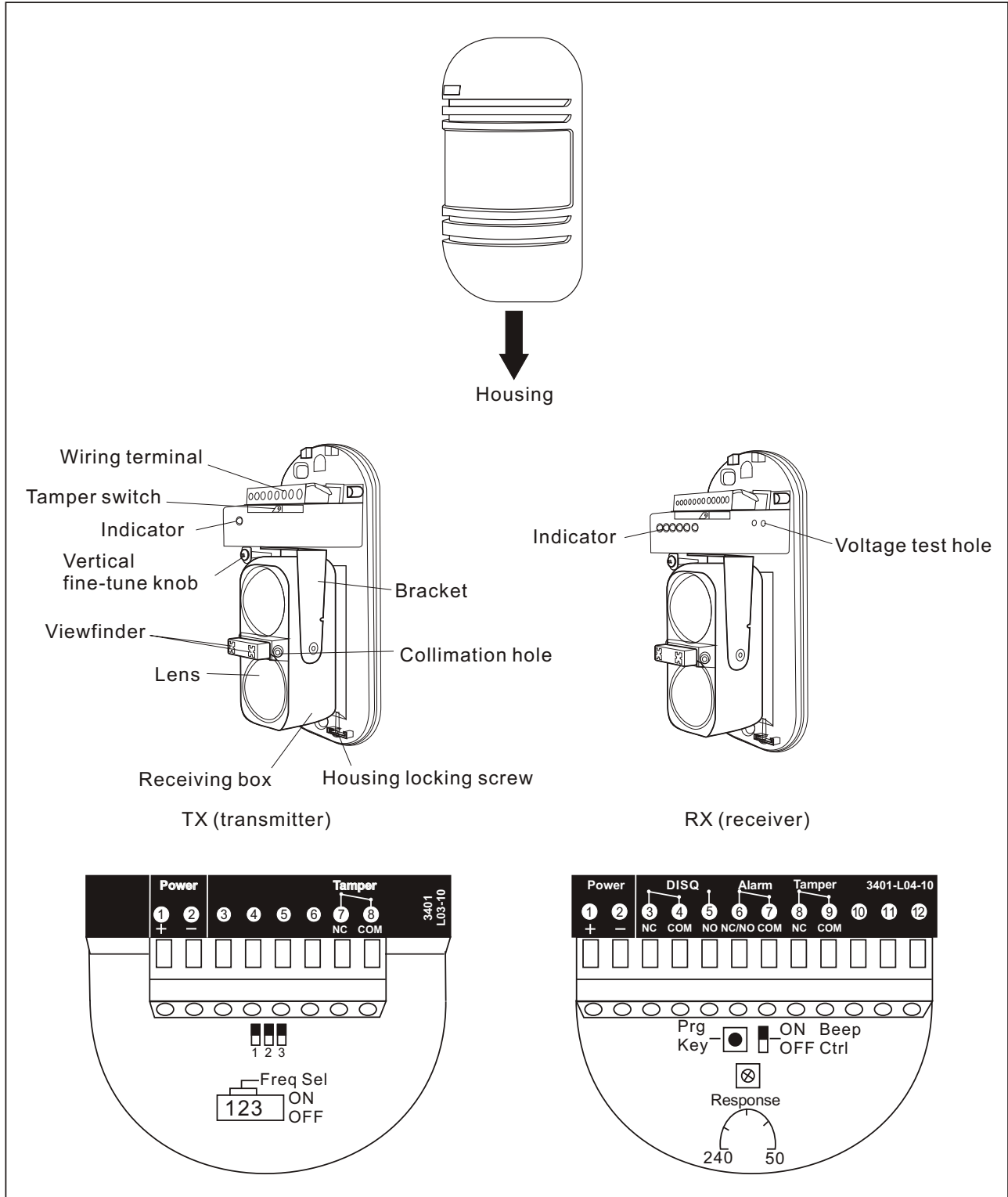

Figure:1