

Product Information

©2020 Hangzhou Hikvision Digital Technology Co., Ltd. All rights reserved.

About this Manual

The Manual includes instructions for using and managing the Product. Pictures, charts, images and all other information hereinafter are for description and explanation only. The information contained in the Manual is subject to change, without notice, due to firmware updates or other reasons. Please find the latest version of this Manual at the Hikvision website (<https://www.hikvision.com/>).

Please use this Manual with the guidance and assistance of professionals trained in supporting the Product.

Trademarks

HIKVISION and other Hikvision's trademarks and logos are the properties of Hikvision in various jurisdictions. Other trademarks and logos mentioned are the properties of their respective owners.



This product and - if applicable - the supplied accessories too are marked with "CE" and comply therefore with the applicable harmonized European standards listed under the RE Directive 2014/53/EU, the EMC Directive 2014/30/EU, the LVD Directive 2014/35/EU, the RoHS Directive 2011/65/EU.



The Input voltage should meet both the SELV (Safety Extra Low Voltage) and the Limited Power Source according to the IEC60950-1 standard. Please refer to technical specifications for detailed information.



2012/19/EU (WEEE directive): Products marked with this symbol cannot be disposed of as unsorted municipal waste in the European Union. For proper recycling, return this product to your local supplier upon the purchase of equivalent new equipment, or dispose of it at designated collection points. For more information see: www.recyclethis.info

Disclaimer

TO THE MAXIMUM EXTENT PERMITTED BY APPLICABLE LAW, THIS MANUAL AND THE PRODUCT DESCRIBED, WITH ITS HARDWARE, SOFTWARE AND FIRMWARE, ARE PROVIDED "AS IS" AND "WITH ALL FAULTS AND ERRORS". HIKVISION MAKES NO WARRANTIES, EXPRESS OR IMPLIED, INCLUDING WITHOUT LIMITATION, MERCHANTABILITY, SATISFACTORY QUALITY, OR FITNESS FOR A PARTICULAR PURPOSE. THE USE OF THE PRODUCT BY YOU IS AT YOUR OWN RISK. IN NO EVENT WILL HIKVISION BE LIABLE TO YOU FOR ANY SPECIAL, CONSEQUENTIAL, INCIDENTAL, OR INDIRECT DAMAGES, INCLUDING, AMONG OTHERS, DAMAGES FOR LOSS OF BUSINESS PROFITS, BUSINESS INTERRUPTION, OR LOSS OF DATA, CORRUPTION OF SYSTEMS, OR LOSS OF DOCUMENTATION, WHETHER BASED ON BREACH OF CONTRACT, TORT (INCLUDING NEGLIGENCE), PRODUCT LIABILITY, OR OTHERWISE, IN CONNECTION WITH THE USE OF THE PRODUCT, EVEN IF HIKVISION HAS BEEN ADVISED OF THE POSSIBILITY OF SUCH DAMAGES OR LOSS.

YOU ACKNOWLEDGE THAT THE NATURE OF INTERNET PROVIDES FOR INHERENT SECURITY RISKS, AND HIKVISION SHALL NOT TAKE ANY RESPONSIBILITIES FOR ABNORMAL OPERATION, PRIVACY LEAKAGE OR OTHER DAMAGES RESULTING FROM CYBER ATTACK, HACKER ATTACK, VIRUS INSPECTION, OR OTHER INTERNET SECURITY RISKS; HOWEVER, HIKVISION WILL PROVIDE TIMELY TECHNICAL SUPPORT IF REQUIRED.

YOU AGREE TO USE THIS PRODUCT IN COMPLIANCE WITH ALL APPLICABLE LAWS, AND YOU ARE SOLELY RESPONSIBLE FOR ENSURING THAT YOUR USE CONFORMS TO THE APPLICABLE LAW. ESPECIALLY, YOU ARE RESPONSIBLE, FOR USING THIS PRODUCT IN A MANNER THAT DOES NOT INFRINGE ON THE RIGHTS OF THIRD PARTIES, INCLUDING WITHOUT LIMITATION, RIGHTS OF PUBLICITY, INTELLECTUAL PROPERTY RIGHTS, OR DATA PROTECTION AND OTHER PRIVACY RIGHTS. YOU SHALL NOT USE THIS PRODUCT FOR ANY PROHIBITED END-USES, INCLUDING THE DEVELOPMENT OR PRODUCTION OF WEAPONS OF MASS DESTRUCTION, THE DEVELOPMENT OR PRODUCTION OF CHEMICAL OR BIOLOGICAL WEAPONS, ANY ACTIVITIES IN THE CONTEXT RELATED TO ANY NUCLEAR EXPLOSIVE OR UNSAFE NUCLEAR FUEL-CYCLE, OR IN SUPPORT OF HUMAN RIGHTS ABUSES.

IN THE EVENT OF ANY CONFLICTS BETWEEN THIS MANUAL AND THE APPLICABLE LAW, THE LATER PREVAILS.

INSTALLATION CAUTION

1. The additional force shall be equal to three times the weight of the equipment but not less than 50N. The equipment and its associated mounting means shall remain secure during the installation. After the installation, the equipment, including any associated mounting plate, shall not be damaged.

2. Install the equipment according to the instructions in this manual.

3. To prevent injury, this equipment must be securely attached to the wall in accordance with the installation instructions.

English

Diagram Reference

1 Components and Beeps

Indicator

Zone Off: Zone works properly
Flashing Red: Zone alarm
Solid Red: Zone fault
Zone Green: Zone bypass



Run
Solid Green: System works properly
Flashing Green: Under programming mode
Flashing Orange: System fault



Armed/Disarmed
Solid Green: Partition disarmed
Flashing Green: Under programming mode/Partition armed
Solid Red: Under walk test mode



Key \rightarrow Status \rightarrow Project \rightarrow Bypass \rightarrow Panic



Buzzer
One Beep \rightarrow Pressing keys/command timed out or too long.
Two Beeps \rightarrow Valid command/Report uploaded.
Five Beeps \rightarrow Invalid command/Failed to upload the report in 60s.
Continuous Beeping For Two Seconds \rightarrow Fault prompt (an additional beep represents an increased fault).
Slowly Continuous Beeps \rightarrow In the Entry/Exit delay status, the Delay zone armed, or 2 min before auto arming/disarming starting.
Rapidly Continuous Beeps \rightarrow In the Entry/Exit delay status, the Delay zone triggered, or 1 min before auto arming/disarming starting.
Rapid Beeps \rightarrow Zone alarm/keypad not registered.
Three Long Beeps and Two Short Beeps \rightarrow Keypad tampered.

2 Address Settings

Configure the address via DIP switch of the keypad before powering on the system. The address should be in the range of 0 to 31. The binary value shown in the diagram is 00010, which means the decimal value is 2. So the address of the keypad is 2.

3 Wiring and Installation

a. Dimension

b. Wiring

c. Install Keypad

\star It is required to insert the screw for tamper alarm.

4 Operation Commands

Scan the QR code to get programming manual of Hybrid control panel.

Specification

	Model	DS-PKG-H4L	DS-PKG-H8L
Interfaces & component	Status indicator	4	2
	Zone indicator	4	8
	TAMPER switch	1	
	RS-485 interface	1	
	Buzzer	1	
	Numeric key	12 (0-9, *, #)	
Function	Display	LED	
	Function key	4 (Project, panic, status, bypass)	
Electrical & battery	Power	12 VDC, 0.25A	
	Consumption	3W	
	Operation temperature	-10°C to 55°C	
Others	Operation humidity	10% to 90%	
	Dimension (W x H x D)	133.9 mm (5.3") x 74.9 mm (1.9") x 27.7 mm	
	Weight	149 g	

Legal and Regulatory Information



1

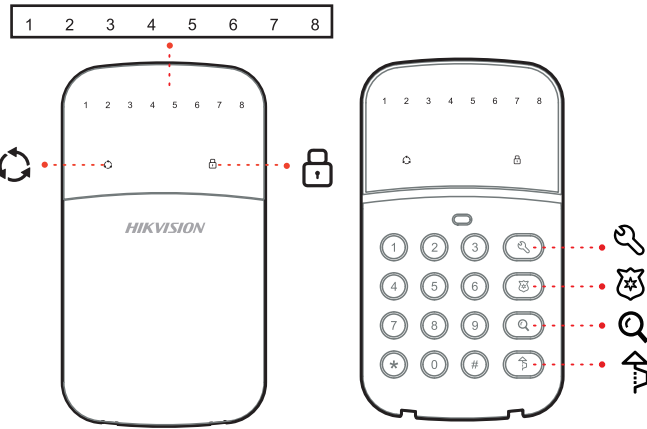

2

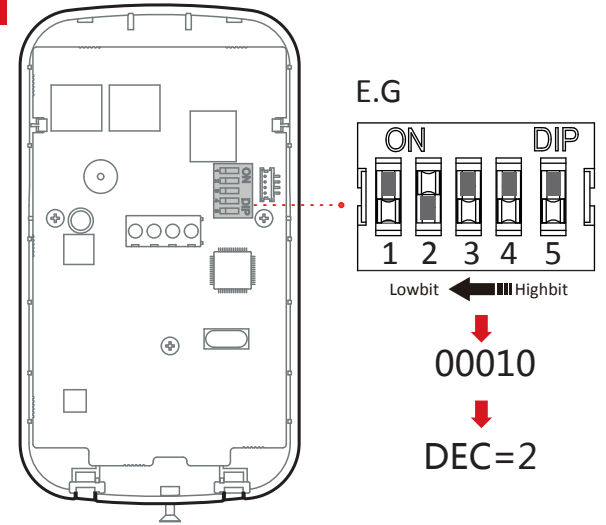

4



3

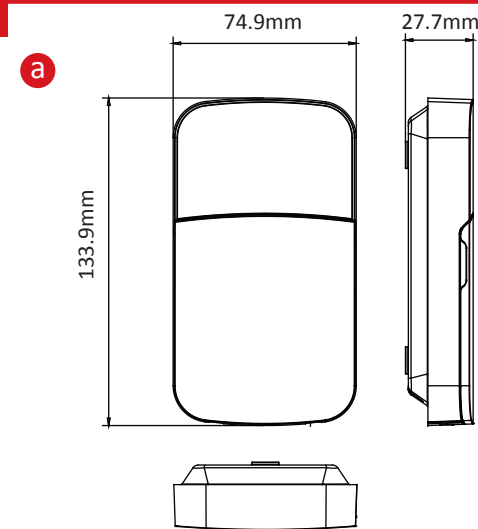

c

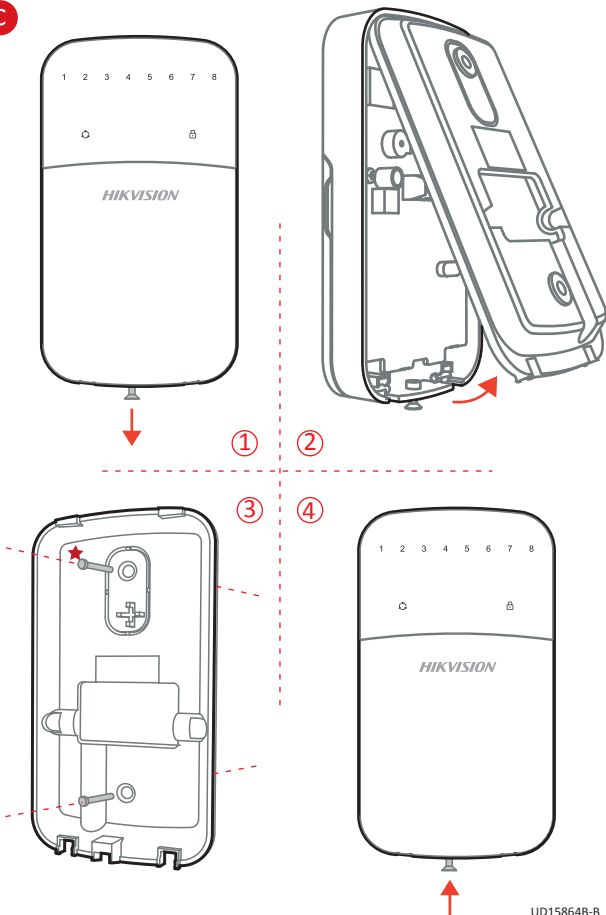

b

