

Quick Start Guide

5-inch Linux Product

Version: 1.0

Overview

M1

[Front](#) / [Bottom](#) / [Rear](#) / [Side](#)

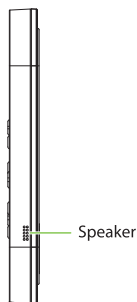
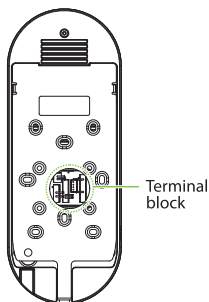
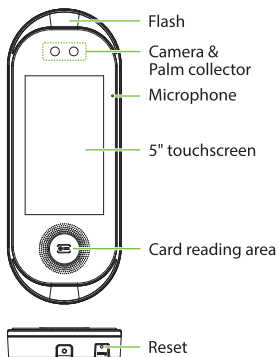

M2

[Front](#) / [Bottom](#) / [Rear](#)

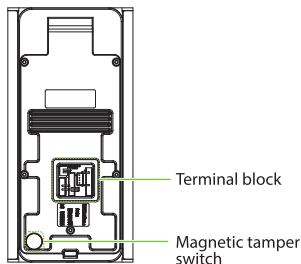
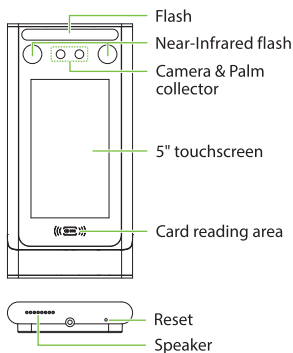

Note: This manual only take M1 as an example for detailed introduction, and the functions of M2 will not be repeated.

Terminal block

12V	Power	RXD2	Tx+	AUX	Auxiliary
GND	In	TXD2	Tx-	GND	input
		GND	Rx+	SEN	Sensor
+12V		RXD	Rx-	GND	
GND		TXD		BUT	Exit Button
IWD0	Wiegand	GND		NOT	
IWD1	in	485A		COM	Lock
WD0	Wiegand	485B		NC1	
WD1	out			AL+	Alarm
				AL-	

Installation Environment

Please refer to the following recommendations for installation.



INSTALL INDOORS
ONLY

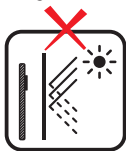

AVOID INSTALLATION
NEAR
GLASS WINDOWS

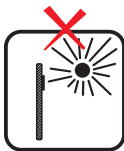

AVOID DIRECT
SUNLIGHT
AND EXPOSURE



AVOID USE OF ANY
HEAT SOURCE
NEAR THE DEVICE

Recommended Palm Gestures

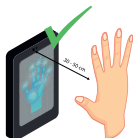

KEEP EFFECTIVE
DISTANCE OF
30-50 cm

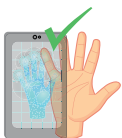

KEEP SPACES
BETWEEN
YOUR FINGERS



DO NOT KEEP
YOUR FINGERS
CLOSE



DO NOT KEEP
PALM OUTSIDE
COLLECTION AREA



DO NOT KEEP
YOUR FINGERS
FOLD/CURLED

Note:

1. Place your palm within **30-50 cm** of the device.
2. Place your palm in the palm collection area, such that the palm is placed parallel to the device.
3. Make sure to keep space between your fingers.

Recommended Standing Position



KEEP EFFECTIVE
DISTANCE OF
0.3-2m

Device Installation

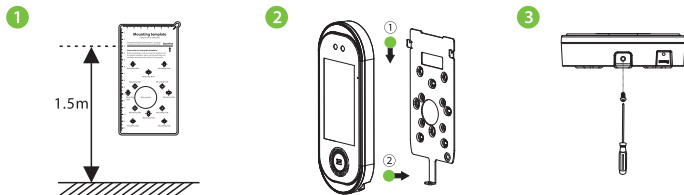

- ① Attach the mounting template sticker to the wall, and drill holes according to the mounting paper. Fix the back plate on the wall using wall mounting screws.
- ② Attach the device to the back plate.
- ③ Fasten the device to the back plate with a security screw.

Standalone Installation

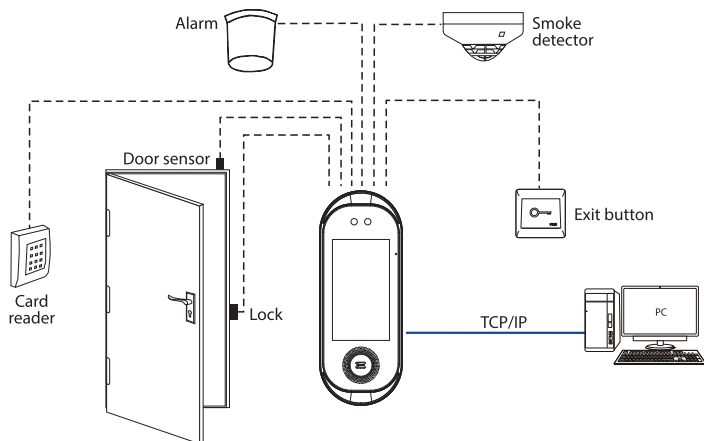

Door Sensor, Exit Button & Alarm Connection

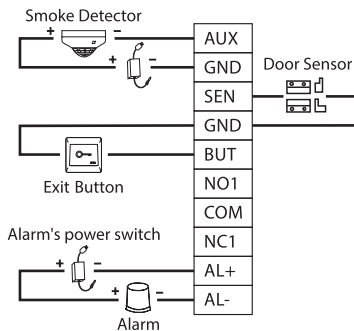
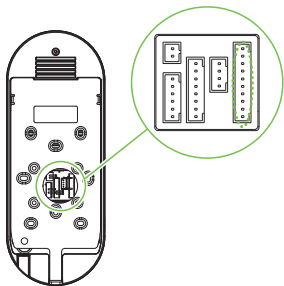

Lock Relay Connection

The system supports Normally Opened Lock and Normally Closed Lock.

The NO LOCK (normally opened at power on) is connected with 'NO1' and 'COM' terminals, and the NC LOCK (normally closed at power on) is connected with 'NC1' and 'COM' terminals. Take NC Lock as an example below:

1) Device not sharing power with the lock

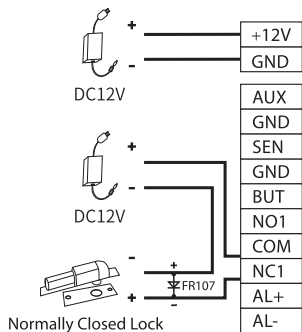

2) Device sharing power with the lock

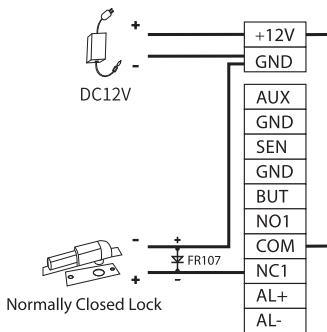

RS485 and RS232 Connection

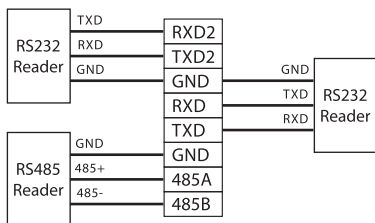
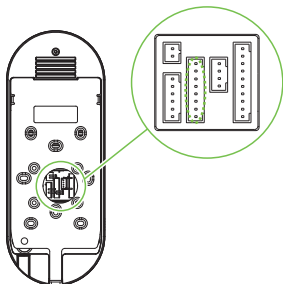

Wiegand Reader Connection

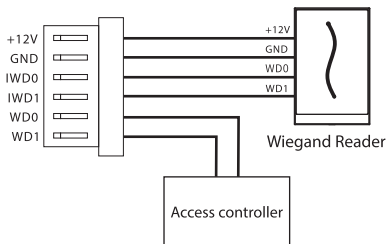
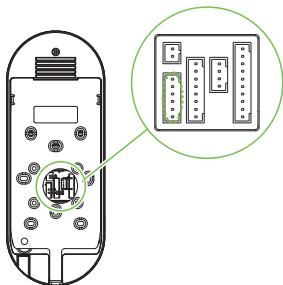

Power Connection

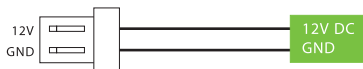
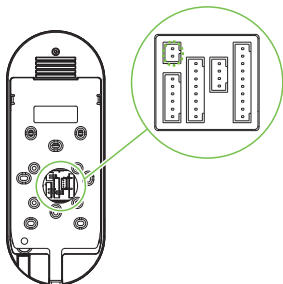

Recommended power supply

- 1) 12V \pm 10%, at least 3000mA.
- 2) To share the power with other devices, use a power supply with higher current ratings.

Ethernet Connection

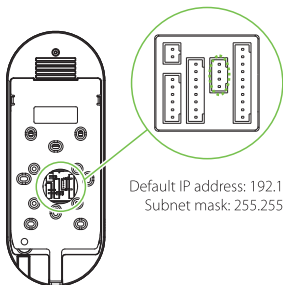

Default IP address: 192.168.1.201
Subnet mask: 255.255.255.0

TX+
TX-
RX+
RX-

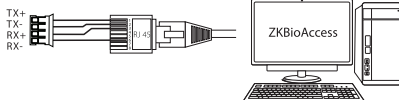

IP address: 192.168.1.130
Subnet mask: 255.255.255.0

Click [COMM.] > [Ethernet] > [IP Address], input the IP address and click [OK].

Note: In LAN, IP addresses of the server (PC) and the device must be in the same network segment when connecting to ZKBioAccess software.

User Registration

When there is no super administrator set in the device, click on  to enter the menu. After setting the super administrator, the system will request for the administrator's verification before entering the menu. For the security purpose, it is recommended to register a super administrator at the first time you use the device.

Method 1: Register on the device

Click on  > [User Mgt.] > [New User] to register a new user. Settings include entering user ID and name, registering a palm, fingerprint, face, password, badge (optional) and user photo, setting user role.

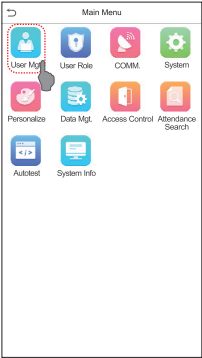
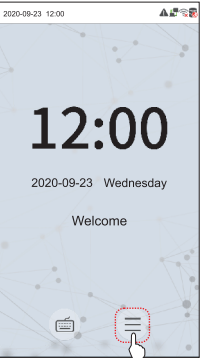

New User	
User ID	1
Name	Mike
User Role	Normal User
Palm	1
Face	1
Badge Number	1
Password
User Photo	1
Access Control Role	

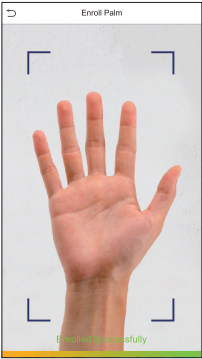

Method 2: Register on ZKBioAccess software

Please set the IP address and cloud service server address on the device.

1. Click **[Access]** > **[Access Device]** > **[Device]** > **[Search Device]** to add the device to the software.

When the device has set the server address and port, it can be added automatically.

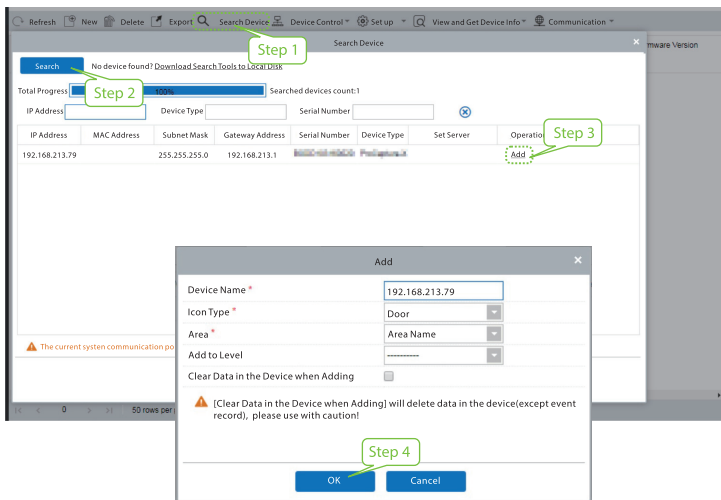

2. Click **[Personnel]** > **[Person]** > **[New]** to register users in the software.

3. Add users to access levels.

4. Click **[Access]** > **[Device]** > **[Device Control]** > **[Synchronize All Data to Devices]**.

For more details, please refer to the ZKBioAccess User Manual.

Method 3: Register on the phone

Once ZKBioAccess software installed, users could enroll face via browser application on their own mobile phone.

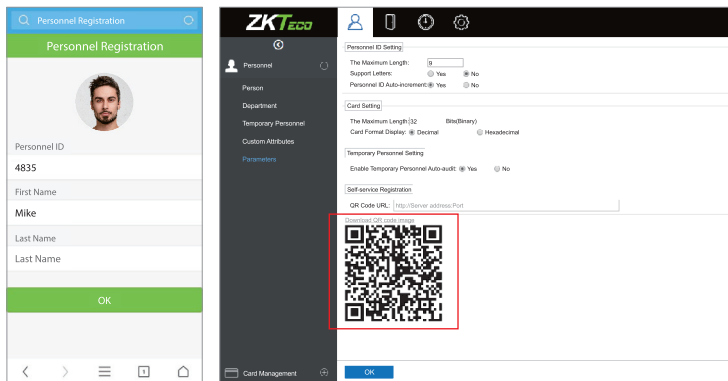

1. Click **[Personnel]** > **[Parameters]**, input “http://Server address:Port” in the QR Code UGL bar. The software will automatically generates a QR code. Scan the QR code or login onto “http://Server address:Port/app/v1/adreg” by the mobile phone to register users.



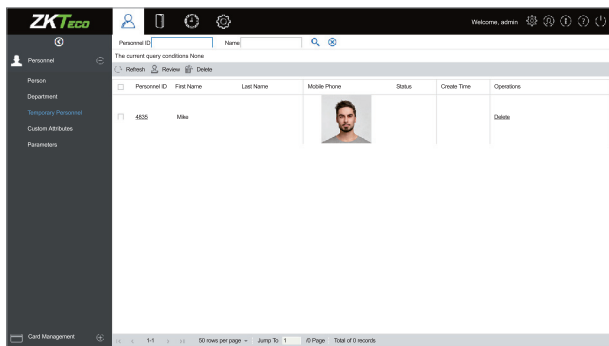

2. The users will display in **[Personnel]** > **[Temporary Personnel]**, click **[Review]**.



Ethernet and Cloud Server Settings

Click on  > [COMM.] > [Ethernet] to set the network parameters. If the TCP/IP communication of the device is successful, the icon  will be displayed in the upper right corner of the standby interface.

Click on  > [COMM.] > [Cloud Server Setting] to set the server address and server port, that is, the IP address and port number of the server after the software is installed. If the device communicates with the server successfully, the icon  will be displayed in the upper right corner of the standby interface.

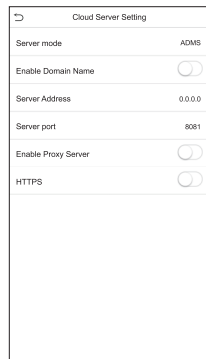
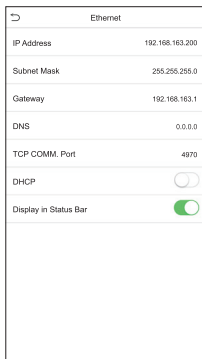
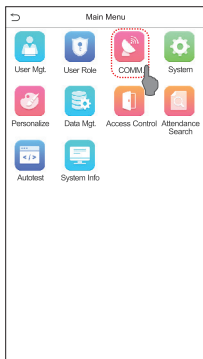

Access Control Settings

Click on  > [Access Control] to enter the access control management interface and set relevant parameters of access control.

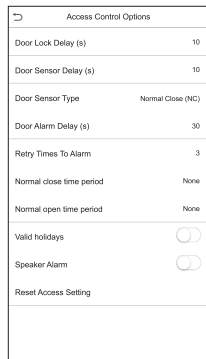
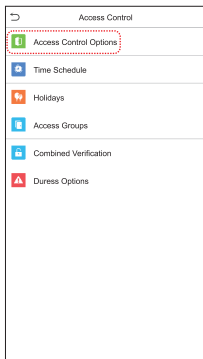
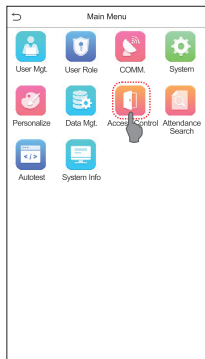

Records Query

Click on > [Attendance Search] > [Attendance Record] to enter the records query interface, input the user ID and select the time range, the corresponding attendance logs will be displayed.

